

DATA SHEET

DVT 3.100

ROTARY VANE PRESSURE/VACUUM PUMPS

oil-free

air-cooled

MAKE IT BECKER.



figure DVT 3.80

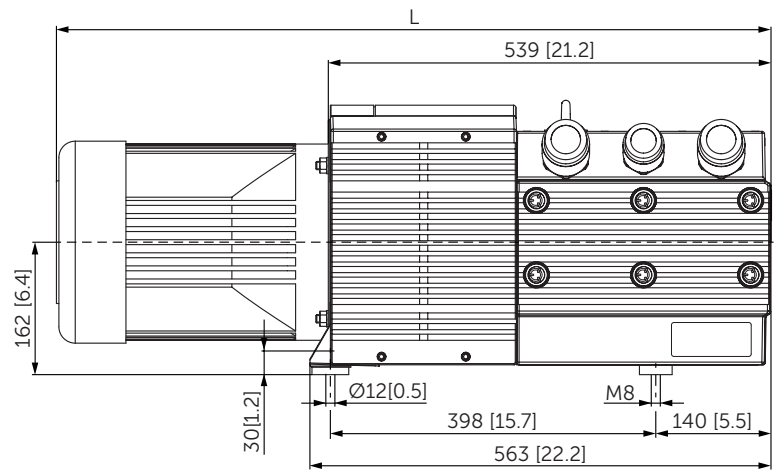
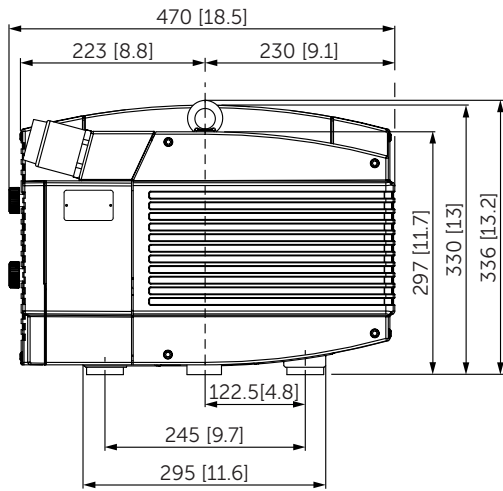

- 1 Pressure connection (G1½)
- 2 Pressure regulating valve
- 3 Option: second suction (G1¼)
- 4 Option: vacuum regulating valve for second suction
- 5 Vacuum connection (G1½)
- 6 Vacuum regulating valve
- Including integrated suction air filter
- The motor illustration may vary.
- Dimensions in mm [inch]

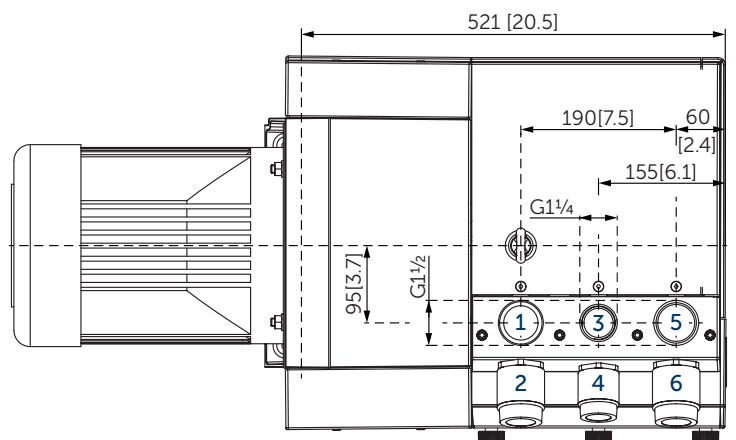

Air rate		Pressure/vacuum relative		Motors		Emission sound pressure level ¹⁾		Weight w/o motor
m ³ /h		bar		kW		dB(A)		kg
50 Hz	60 Hz	50 Hz	60 Hz	50 Hz	60 Hz	50 Hz	60 Hz	
103	120	±0.5	±0.5	5.5	6.6	76-77	77-78	71
103	120	±0.6	±0.6	5.5	6.6	76-77	77-78	71

¹⁾ According to DIN EN ISO 3744 (KpA = 3 dB(A)), 1 m [39.4 inch] distance, at medium load, both connection sides piped

3~ Motors												L	
#	50 Hz				60 Hz				Version	Weight kg	mm [inch]		
	kW	V	min ⁻¹	A	kW	V	min ⁻¹	A					
01	5,5	Δ400	IE3	1470	12,3	6,6	Δ460	IE3	1765	12,0	IP55 • ISO F • bimetal	53,0	913 [36,0]
							Δ400			1751			
02						6,6	YY230/Y460	IE3	1768	23,9/11,95	UL(E365362) • CSA IP55 • ISO F • bimetal	63,5	951 [37,5]
							YY208			1760			
03	5,5	Δ200/Y350	IE3	1465	21,5/12,4	6,6	Δ220/Y380-400	IE3	1755	22,5/13,2-12,7	UL(E365362) • CSA CC334B IP55 • ISO F • bimetal	63,5	951 [37,5]
							Δ200/Y350			1740			
04						6,6	Δ400/Y690	IE3	1760	12,5/7,2	UL(E365362) • CSA CC334B IP55 • ISO F • bimetal	63,5	951 [37,5]

- Current consumption and rotation speed may vary. Tolerance in each case -1.5/+2%

Air rates • power consumptions • temperatures										
relative pressure			relative vacuum							
			50 Hz				60 Hz			
			0 bar	-0.4 bar	-0.5 bar	-0.6 bar	0 bar	-0.4 bar	-0.5 bar	-0.6 bar
+0.4 bar	Suction air rate	m ³ /h	95.7	51.0	40.5	29.8	112.6	62.1	49.9	37.7
	Blast air rate	m ³ /h	98.2	74.6	67.1	58.7	117.6	87.6	77.9	67.7
	Power consumption	kW	3.16	3.88	3.99	4.10	4.44	5.00	5.04	5.11
	Temperature compressed air	°C	38	42	42	43	41	45	45	45
+0.5 bar	Suction air rate	m ³ /h	95.6	51.0	40.2	29.7	113.7	62.6	50.0	37.6
	Blast air rate	m ³ /h	98.0	74.7	66.9	58.8	119	88.3	78.2	67.8
	Power consumption	kW	3.28	4.01	4.11	4.22	4.51	5.14	5.20	5.28
	Temperature compressed air	°C	39	43	44	44	43	46	46	46
+0.6 bar	Suction air rate	m ³ /h	96.1	50.2	39.9	29.9	112.7	61.9	49.3	37.6
	Blast air rate	m ³ /h	98.5	73.7	66.6	58.8	117.8	87.7	77.7	67.9
	Power consumption	kW	3.43	4.17	4.27	4.37	4.66	5.29	5.37	5.44
	Temperature compressed air	°C	40	44	45	45	43	46	46	46

Reference data (atmosphere): 1000 mbar (100 kPa), 20°C (68°F)

Tolerance: ±5%

+ VARIANTS AND ACCESSORIES

- With first and second suction
- With external suction filter¹⁾
- Sound proof box SH 13¹⁾



Example for an external suction filter



Sound proof box SH 13

¹⁾ See separate data sheet

- Possible combinations on request



MAKE IT BECKER.